



Dr. Prepare

LED CHRISTMAS PROJECTOR (SNOW EFFECTS)

Model: DPL-0CL01

 **Manual**

WARNINGS

1. Please make sure the power is off before installation.
2. Please do not disassemble or alter the product.
3. Please follow the instructions from our user manual to use this projector.
4. Please use the supplied power adapter only.
5. We advise you not to use the projector continuously over 4 hours each time.

SPECIFICATIONS

Input Voltage	AC100V- 240V
Output Voltage	14V / 300mA
Light Source	5W LED
Ingress Protection Rating	IP65
Length of Power Cord	16.4ft / 5m

ACCESSORIES

- | | |
|----------------------------------|-------------------|
| Projector * 1 | Power Adapter * 1 |
| Ground Stake * 1 | User Manual * 1 |
| Round Base * 1 | Screws * 2 |
| Quick-Release Knob & Hex Nut * 1 | |

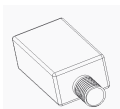

Power Adapter



Ground Stake



Projector



Round Base



Screws

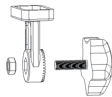

Quick-Release
Knob & Hex Nut

MAINTENANCE

1. Please clean the lamp regularly to ensure performance of the projector. Make sure the power is cut off before maintenance.
2. To avoid any damages to the projector, please do not use chemical cleaning solvent for routine maintenance.

ASSEMBLY INSTRUCTIONS

1. Attach the bracket to the projector with two screws (see fig. 1).
2. Use the hex nut and knob to fasten the bracket under the projector and the stake (see fig. 1).
3. Connect the 2-pin power cord with the included power adapter. Fasten two parts to ensure secure connection.

